

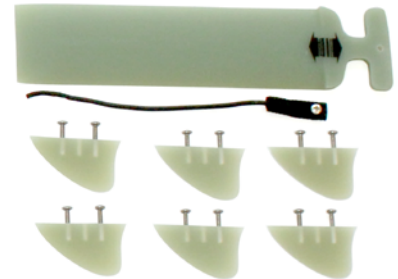

FLYSURFER
KITEBOARDING



FLY Race



Calculated
3D FLEX



ERGONOMIC
TOESIDE



Optimized for
RACING



ADJUSTABLE
FIN SYSTEM



FLEXTIP
CHOP CONTROL



WIDE
STANCE



WOOD-FOAM
CORE



Shaped by

EDDY
LANSINK

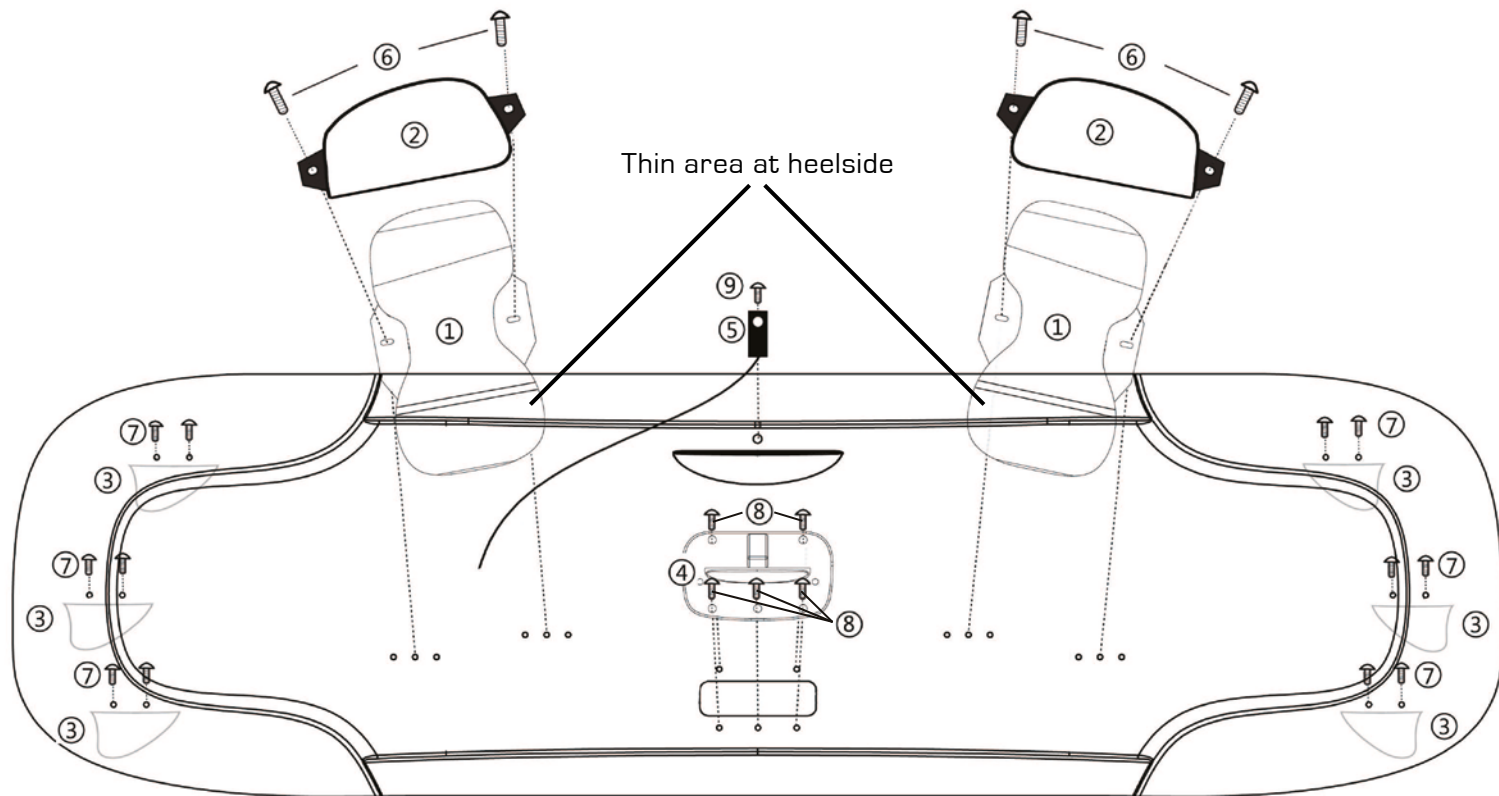

- ① Footpads
- ② Footstraps
- ③ Tip Fin 6 cm

- ④ Fin Adjustment System
- ⑤ Bungee Line
- ⑥ Screws for Footstrap 20 mm

- ⑦ Screws for Tip Fin 20 mm
- ⑧ Screws for Fin Adjustment System 16mm
- ⑨ Screw for Bungee Line 12 mm



1. Insert the screw (20 mm) through the strap and the pad into the insert of the board and tighten the screw by using a screwdriver.

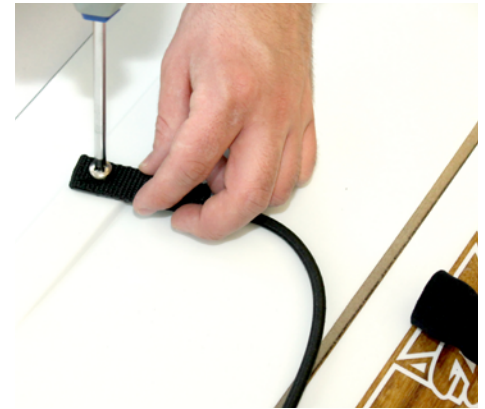

2. Attach the bungee line to the board by screwing it (12 mm) into the insert.

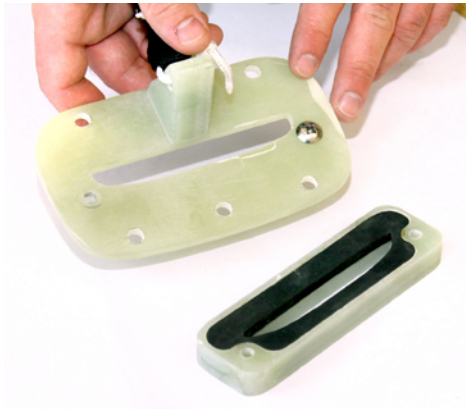

3. Assemble the fin adjustment system with the black rubber-surface facing upwards.

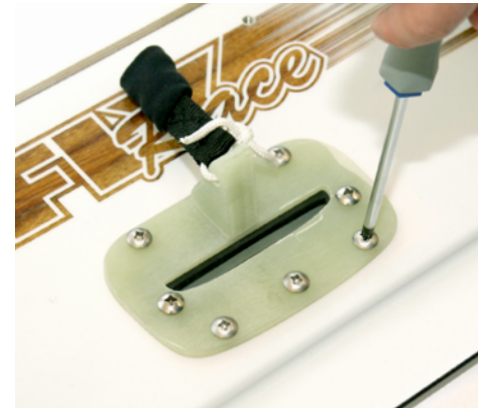

4. Screw the assembled fin adjustment system on to the board (16 mm screws).



5. Fix the tip fins to the board using the 20 mm screws (2 per fin) and tighten the screws.

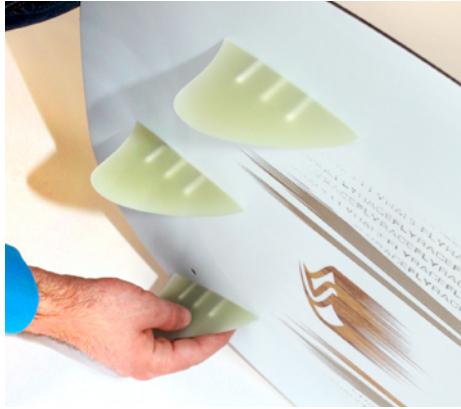

6. Put the rubber line through the fin and make a knot



7. Make a loop with the adjustment strap and wrap it around the fin handle.

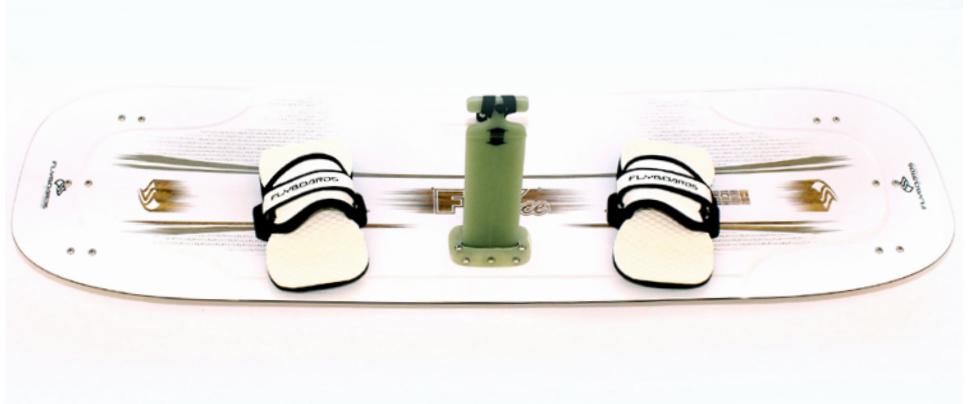

RIDING ADVICE > Keep board flat while riding
> Learn to ride with the fin, by increasing depth step by step

FLYSURFER Kiteboarding

Brand of Skywalk GmbH & Co. KG

Windeckstr. 4

83250 MARQUARTSTEIN, GERMANY

☎ +49 (0) 86 41 69 48 - 30

🌐 www.flysurfer.com

✉ info@flysurfer.com

